



23 m FIREFIGHTING & RESCUE VESSEL

ROLES

The design and specification of the 23 m FRV makes it highly suitable for the following roles:

- 1: Firefighting**
- 2: SAR**
- 3: Offshore patrolling**
- 4: Command and Control Centre**
- 5: Maritime surveillance**
- 6: Command and Control Centre**
- 7: Humanitarian and Disaster relief and rescue**

Main Characteristics:

Hull Type	Catamaran
Displacement	92.00 t
Length Overall	23.98 m
Length Hull	22.00 m
Length Water Line	21.18 m
Breadth	8.00 m
Max Draught	1.73 m
Max Speed	30 kt
Service Speed	25 kt
Fuel	10,000 Litres
Fresh Water	1,000 Litres
Black/Grey	1,000 Litres

Classification:

Classification society	BV Hull and Machinery
Classification code	MCA
Sea State Code	3-4
Flag state	UK
Operational Area	Coast Waters UK and Europa

Passenger Capacity:

Crew	4
Passengers	6 + 2 stretcher

Cargo Capacity:

Deck	3 x 500 kg
------	------------

Operational Features:

Operating time	24 hr
Power sockets Fwd deck	
Power sockets aft deck	
Sufficient storage area for tools, equipment and luggage	
1 anchor windless	
1 dive platforms	
All lighting LED	
Full monitoring of main engines, gen set, tanks and alarms at the helm 2 x 12 "LCD displays.	

Fire Fighting:

- 1,500 Lts of Foam
- 2 x Fire Pumps FFS SFP 150x200 at 680m³/h
- 2 x Fwd mounted Water Monitor FFS600 with remote control
- 2 x Roof mounted Water Monitor FFS600 with remote control
- 1 x Water Monitor FFS600 with manual operation fitted to the port aft deck
- 1 x Water Monitor FFS600 with manual operation fitted to the stbd aft deck
- 1 x 4 Outlet Hydrant outlets with UK standard coupler

Accommodation:

- 8 x 70 mm x 20 m Firefighting Hose with British Instantaneous connection
- 4 x 45 mm x 20 m Firefighting Hose with British Instantaneous connection
- 1 x AWG Branch with British Instantaneous connection
- 2 x Hand Controlled Branch British Instantaneous connection
- 1 x AWG Ejector Pump British Instantaneous connection
- 1 x Hydroschild Water Curtain British Instantaneous connection
- 1 x Controlled dividing 2 ½ " British Instantaneous connection
- 1 x TIC
- 1 x Microvent resuscitation kit
- 1 x Defibrillator
- 1 x Major First Aid Kit
- 1 x Hooligan Crowbar
- 3 x Crash Axe
- 3 x Bolt Cutters
- 1 x Sledge Hammer
- 1 x Claw Hammer
- 1 x Spike Hammer
- 4 x Breathing Apparatus
- 1 x Angus LDA400 Light Portable Pump 400L/M at 5 Bar
- 2 x Hard Suction
- 1 x Basket and strainer
- 1 x Suction Wrench
- 1 x Cobra Cold cut system

Accommodation:

Wheelhouse to have 4 dampened seat for the crew, coxswain and navigator in the Fwd seats.
 Commander and engine in the aft seats.
 Main Cabin 6 x dampened seat
 Storage area for passenger's luggage and equipment
 Personal plug for PC/phone.
 2 x Heads
 2 x Showers
 4 x Crew cabin with 8 bunks for 24 hr operations
 Fully Air conditioned incl de-misting and heating
 Galley
 Low noise and vibration

Propulsion & Gen Sets:

Propulsion	2 x RR 56A3
Engines	2 x MTU 12 V 2000 M72
Generator	2 x 27 Kw 380 V 50 Hz

24 VDC starting for Main Engines and Gen Sets
 Main 24 VDC battery bank with UPS for critical systems.
 Emergency Battery in wheelhouse.
 Solar panel option for main 24 VDC systems

Navigational Equipment:

2 X Radar
 4 x 19 " LCD Display
 Autopilot
 Nav tex
 AIS
 2 GPS
 4 G mobile
 Inmarsat Fleet Broadband
 Satellite compass
 Talkback/PA system and loud hailer
 Four crew positions to be provided with inter comm two way voice conferences.
 Speed log
 Echo sounder
 Anemometer
 1 x GMDSS MF/HF DSC radio
 2 x GMDSS VHF DSC radio
 FLIR and display
 2 x remotely controlled search light auto tracking to radar
 Integrated Bridge Control Navigation
 iRAMC (Intelligent Remote Asset Monitoring)
 CCTV with 24 hr recording and disp

PRINCIPAL PARTICULARS

LENGTH OVERALL	23.96 m
LENGTH HULL	22.00 m
LENGTH WATERLINE	21.16 m
MAXIMUM BEAM	8.30 m
MAXIMUM DRRUGHT	1.73 m
MAXIMUM DISPLACEMENT	22.00 t
LOADLINE LENGTH	22.37 m
DECK CARGO	15.0 t
FUEL OIL CAPACITY	10.0 m ³
FUEL OIL CARGO CAPACITY	8.0 m ³
FRESH WATER CAPACITY	1.0 m ³
WASTE WATER CAPACITY	1.0 m ³
MAIN ENGINES	2 x MTU 12V 2000 M72
DECK AREA FWD/AFT	42.00 m ² / 34.5 m ²
PROPULSION	2 x ROLLS ROYCE 66A3
MAXIMUM SPEED	30.0 kn (55.06 KPH)
SERVICE SPEED	25.0 kn (46.35 KPH)
CLASS NOTATION	BY RINA FARM SERVICE SHIP S1
FLAG	UK FLAG WORKBOAT CODE CAT 1

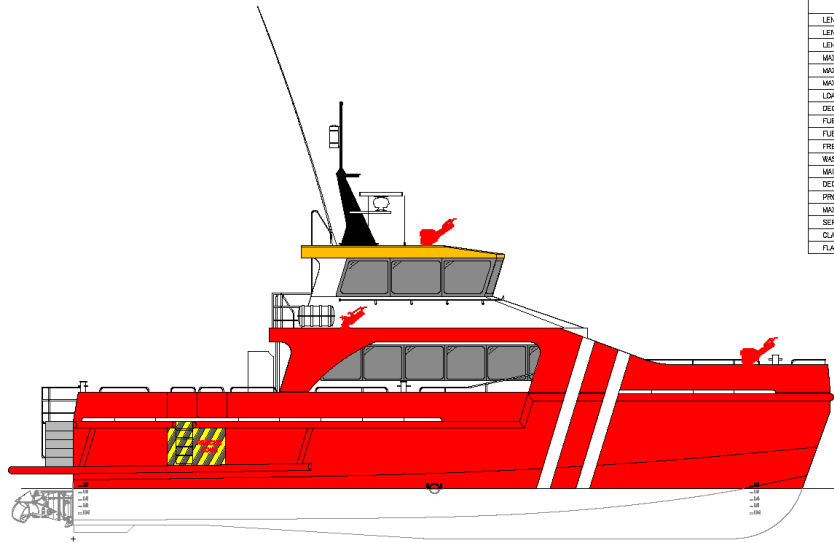

OUTBOARD PROFILE

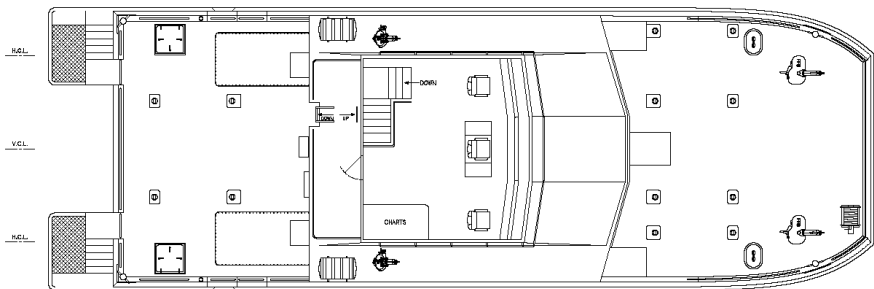

PLAN VIEW BRIDGE DECK

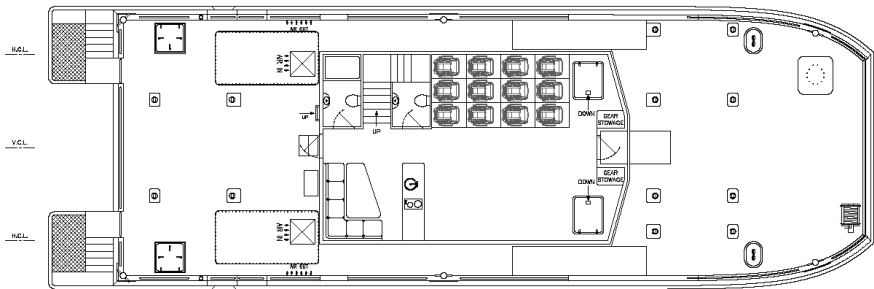

PLAN VIEW MAIN DECK

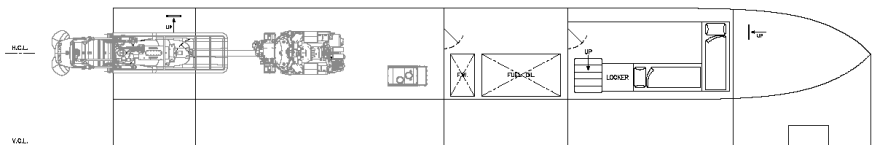

PLAN VIEW HULL

UNCONTROLLED COPY
NOT TO BE USED FOR MANUFACTURE

PROJECT : 23m FIRE BOAT

TITLE : GENERAL ARRANGEMENT

DWG No : FB23-700-01

Weight (KG)	N/A
Checked By	-
Checked Date	-
Drawn By	J.W.
Drawn Date	17/04/18

Sheet of	1	Issue	A	Scale	1:60
----------	---	-------	---	-------	------

ISSUE	MODIFICATION	MOD. DATE
A	INITIAL DRAWING ISSUE	17/04/2018